

User Manual

Accessories

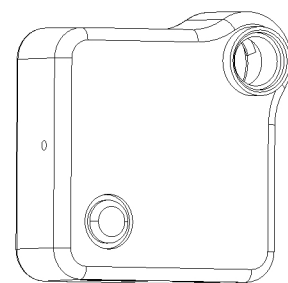

Cooky Cam



USB Cable(Micro-B)

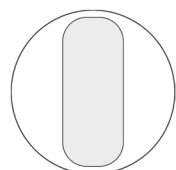

Magnetic Clip

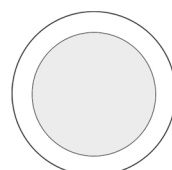

Magnetic Sticker

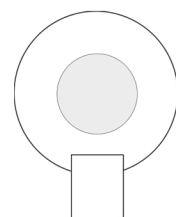

Magnetic Multipurpose Mount

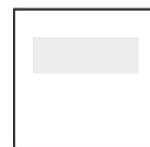

Manual

Component

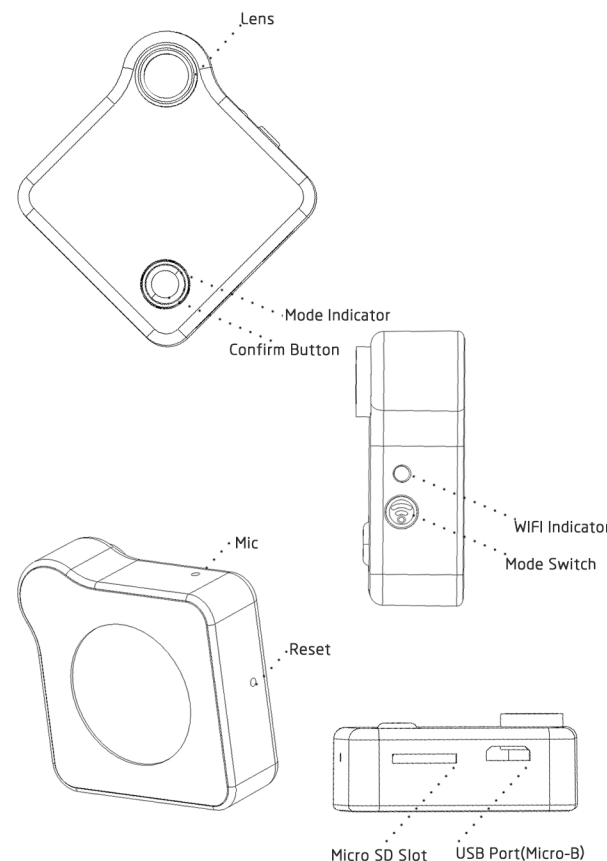

At Beginning

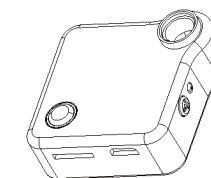

1. Insert a Micro SD Card, Class6 or above (Maximum 32GB).
2. Connect to any power supply port via Micro USB Cable. Charging about 2 hours until Mode indicator off.
3. Press Confirm button about 3 seconds, Cooky Camera will turn on and initialization (Red & Blue Indicator Flash). After initialization, the Mode indicator will be on Red.
4. Click Mode Switch button to Change the Working Mode (Video/Photo/Motion Sensor).
5. On working status, press Confirm button about 3 seconds, Cooky Camera will turn off.

Working Mode

Click "Mode Switch" Button to Change Working Mode.

1. Video Mode - Red Indicator

Click Confirm button, Red Indicator flash, camera start video recording. Click Confirm button, Red Indicator constant Light, Video Recording Standby.

2. Photo Mode - Blue Indicator

Click Confirm button, Blue Indicator flash, camera start Photo taken. Click Confirm button, Blue Indicator constant Light. Photo Taken standby.

3. Motion Sensor - Red & Blue Indicator

Motion Sensor Indicator Red & Blue constant Light. When lens found there have things moving at the front, it will start Video recording. Blue indicator constant light, Red Indicator flash.

4. Charging While Recording

It can charging via USB Cable. When its charging, Mode indicator Red & Blue constant Light. The indicator will be off after full charging. Click Confirm button when its charging, then the camera will be turn on. Now its under Charging while Recording.

AP Connect



Download p2pCamViewer App in store
Use your smart phone wifi connect the Camera.

1. Power on: Press Confirm Button 3 seconds and wait initialization finished.
2. Connect Mobile: Open WLAN, choose CookyCam, enter password 12345678 (default)
3. Open APP: Click the APP and use the smart phone to control the camera.

Through the APP, you can preview image, controlling the camera and download the files.
In camera setting, you can set the camera.



Remote IP Connect

Set the Remote connect to watch the real-time video via Internet.
Remote Connect Setting:

1. Power on: Press Confirm Button 3 seconds and wait initialization finished.
2. Connect Mobile: Open WLAN, choose CookyCam, enter password 12345678 (default)
3. Open APP: Click Camera Setting
4. Find Wireless Setting, input local WIFI name and password.
5. The Camera will reboot after success setting Remote IP Connect. Please check your smart phone network if working, then logo in ID Number and Password 12345678 (default) for remote connect and Watch the real-time video.

Warning:
After the first time logo
Please Change the Password !!!

Specifications

Video Resolution: HD 1280x720P
Photo Resolution: 1280x720 JPG
File Format: .MP4 (H.264 Coded)
Sensor Type: CMOS
View Angle: 78° Optical first person view angle
Focus: 0.5 - ∞
IOS: 50 - 6400
Mic: Built in noise canceling microphone
External Storage: Micro SD Card, Max. 32GB
System: Windows XP / Mac OS 10.2 or above
Remote Control: P2P Connect/ Remote Connect
Dimension: 40x40x15mm
Weights: 32g
Battery: Built-in 600mAh